



CAINTON

Change is a perpetual motion

AC Cross Flow Fan

- Code Rule - p.1
- AC Cross Flow Fan - pp. 2 - 86

Code Rule

Fan Type	Fan imension (mm)		Voltage	Speed	Connection	Mold Model	IP Level
	Impeller Diameter	Air Outlet Length					
FLA: AC Cross Flow Fan			V1: 115VAC	HX: Higher than Extreme	C: Connector	-Mold Model	-IP Level
			V2: 230VAC	XH: Extremely High			
			FV: Full Voltage	HH: Much Higher			
				HR: Higher			
				H: High			
				M: Medium			
				L: Low			
				LR: Lower			
				LW: Much Lower			
				XL: Extremely Low			
				LX: Lower than Extreme			

AC Cross Fan

Ø30

- Housing: Metal
- Impeller: Aluminum
- Protection: Impedance Protection
- Certification: CE, RoHS
- Additional functions are optional



Model	Voltage	Frequency	Current	Power	Speed	Air Flow	Pressure	Noise
	VAC	Hz	Amp	Watt	RPM	m3/h	Pa	dB(A)
FLA30530-M	230	50	0.14	17	2400	100	18	33
FLA30610-M	230	50	0.15	17	2400	115	18	32
FLA30718-M	230	50	0.15	18	2400	120	18	35
FLA30800-M	230	50	0.15	18	2400	110	17	35
FLA30854-M	230	50	0.15	18	2400	135	17	36
FLA30920-M	230	50	0.15	18	2400	145	17	36
FLA30986-M	230	50	0.15	18	2400	170	17	38

AC Cross Flow Fan Ø30

- Dimension:

Unit: mm

Model	Air Outlet Length (C)	Pitch Row (B)	Total Length (A)	Curve
	mm	mm	mm	
FLA30530-M	530	540	605	Ⓐ
FLA30610-M	610	620	685	Ⓑ
FLA30718-M	718	728	793	Ⓒ
FLA30800-M	800	810	875	Ⓓ
FLA30854-M	854	864	929	Ⓔ
FLA30920-M	920	930	995	Ⓕ
FLA30986-M	986	996	1061	Ⓖ

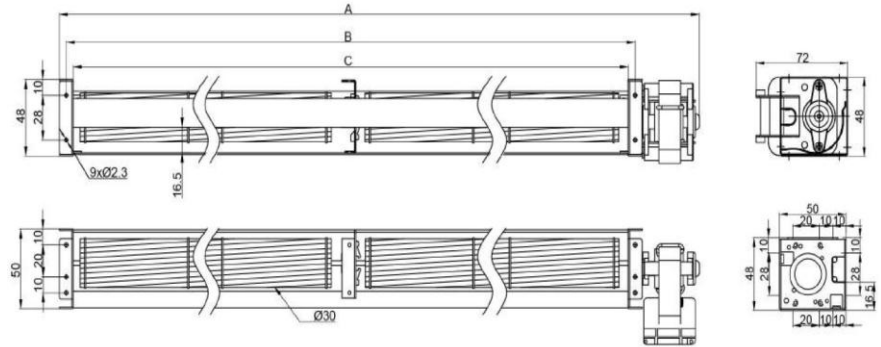

AC Cross Flow Fan

Ø30

- Performance:

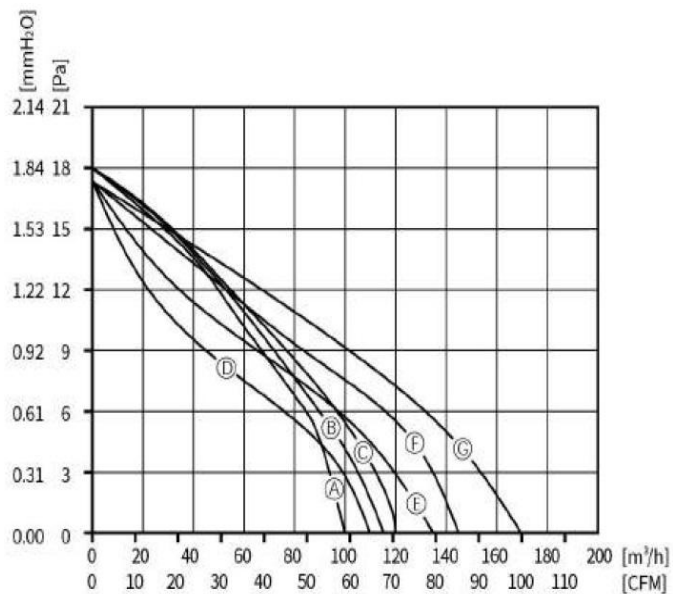

AC Cross Fan

Ø30 - B Type

- Housing: Metal
- Impeller: Aluminum
- Protection: Impedance Protection
- Certification: CE, RoHS
- Additional functions are optional



Model	Voltage	Frequency	Current	Power	Speed	Air Flow	Pressure	Noise
	VAC	Hz	Amp	Watt	RPM	m3/h	Pa	dB(A)
FLA30198V2-M2	230	50	0.1	12	2600	34	7.5	30
FLA30248V2-M2	230	50	0.12	13	2600	43	7.5	32
FLA30300V2-M2	230	50	0.12	12	2600	52	7.3	34
FLA30352V2-M2	230	50	0.11	11.2	2600	58	7.5	36
FLA30420V2-M2	230	50	0.08	11.5	2600	70	7.2	36

AC Cross Flow Fan

Ø30 - B Type

- Dimension:

Unit: mm

Model	Air Outlet Length (C)	Pitch Row (B)	Total Length (A)	Curve
	mm	mm	mm	
FLA30198V2-M2	198	208	263	Ⓐ
FLA30248V2-M2	248	258	313	Ⓑ
FLA30300V2-M2	300	310	365	Ⓒ
FLA30352V2-M2	352	362	417	Ⓓ
FLA30420V2-M2	420	430	485	Ⓔ

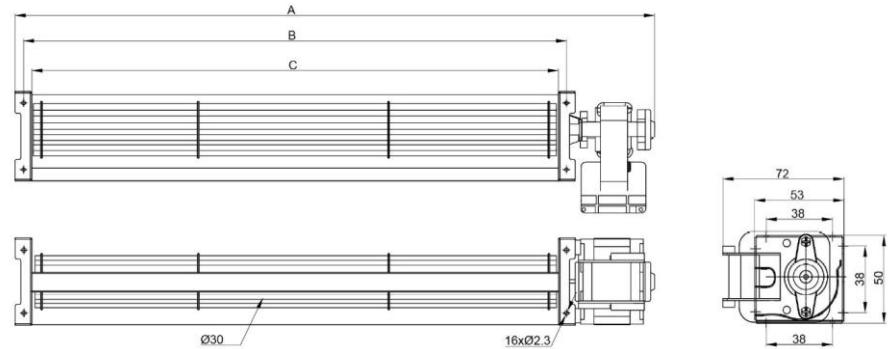

AC Cross Flow Fan

Ø30 - B Type

- Performance:

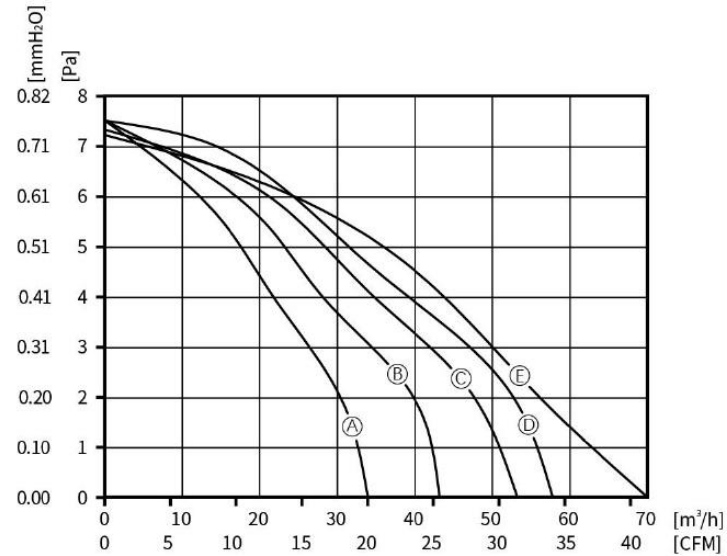

AC Cross Fan

Ø30 - C Type

- Housing: Metal
- Impeller: Aluminum
- Protection: Impedance Protection
- Certification: CE, RoHS
- Additional functions are optional



Model	Voltage	Frequency	Current	Power	Speed	Air Flow	Pressure	Noise
	VAC	Hz	Amp	Watt	RPM	m3/h	Pa	dB(A)
FLA3098V1-M3	115	60	0.25	15.3	3300	25	11	31
FLA3098V2-M3	230	50	0.11	13.5	2700	20	10	31
FLA30160V1-M3	115	60	0.25	16.5	3200	48	11	32
FLA30160V2-M3	230	50	0.11	13.4	2700	41	10	32
FLA30198V1-M3	115	60	0.25	15.8	3100	60	13	32
FLA30198V2-M3	230	50	0.11	13.7	2600	50	10	32
FLA30248V1-M3	115	60	0.25	15.8	3100	60	13	32
FLA30248V2-M3	230	50	0.11	14.4	2500	62	10	32

AC Cross Fan

Ø30 - C Type

- Housing: Metal
- Impeller: Aluminum
- Protection: Impedance Protection
- Certification: CE, RoHS
- Additional functions are optional



Model	Voltage	Frequency	Current	Power	Speed	Air Flow	Pressure	Noise
	VAC	Hz	Amp	Watt	RPM	m3/h	Pa	dB(A)
FLA30300V1-M3	115	60	0.25	16.7	2900	90	15	34
FLA30300V2-M3	230	50	0.11	14.4	2500	81	13	33
FLA30352V1-M3	115	60	0.26	16.9	2780	106	15	35
FLA30352V2-M3	230	50	0.14	14.4	2500	96	14	35
FLA30420V1-M3	115	60	0.27	19.5	2500	110	15	36
FLA30420V2-M3	230	50	0.15	17.5	2500	110	15	36

AC Cross Flow Fan

Ø30 - C Type

- Dimension:

Unit: mm

Model	Air Outlet Length (C)	Pitch Row (B)	Total Length (A)	Curve
	mm	mm	mm	
FLA3098V1-M3	98	108	158	Ⓐ
FLA3098V2-M3	98	108	158	Ⓐ
FLA30160V1-M3	160	170	222	Ⓑ
FLA30160V2-M3	160	170	222	Ⓑ
FLA30198V1-M3	198	208	258	Ⓒ
FLA30198V2-M3	198	208	258	Ⓒ
FLA30248V1-M3	248	258	308	Ⓓ
FLA30248V2-M3	248	258	308	Ⓓ
FLA30300V1-M3	300	310	360	Ⓔ
FLA30300V2-M3	300	310	360	Ⓔ
FLA30352V1-M3	352	362	412	Ⓕ
FLA30352V2-M3	352	362	412	Ⓕ
FLA30420V1-M3	420	430	480	Ⓖ
FLA30420V2-M3	420	430	480	Ⓖ

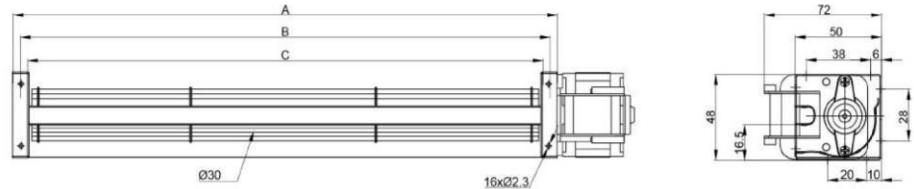

AC Cross Flow Fan

Ø30 - C Type

- Performance:

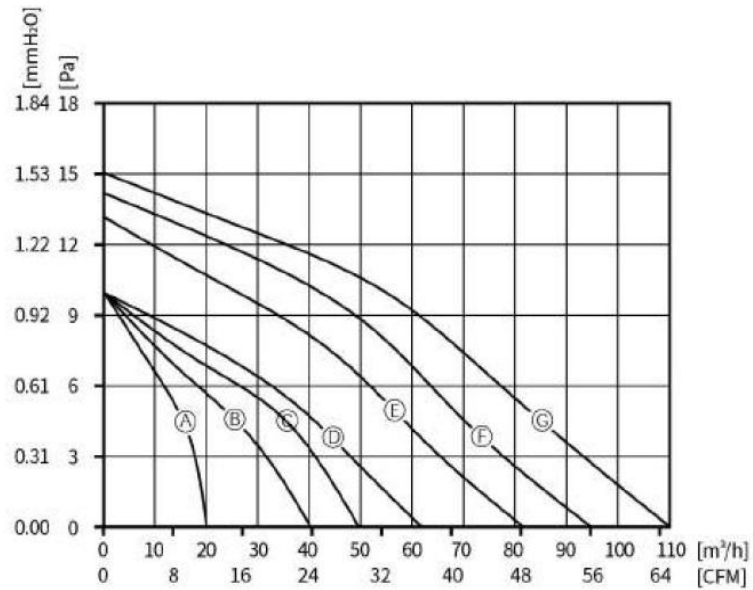

AC Cross Fan

Ø40

- Housing: Metal
- Impeller: Aluminum
- Protection: Impedance Protection
- Certification: CE, RoHS
- Additional functions are optional



Model	Voltage	Frequency	Current	Power	Speed	Air Flow	Pressure	Noise
	VAC	Hz	Amp	Watt	RPM	m3/h	Pa	dB(A)
FLA40530V2-M	230	50	0.16	20	2000	140	19	36
FLA40610V2-M	230	50	0.16	20	1950	150	19	35
FLA40700V2-M	230	50	0.16	21	1750	155	18	34
FLA40800V2-M	230	50	0.14	16	2300	205	18	36
FLA40854V2-M	230	50	0.14	16	2200	209	18	37
FLA40920V2-M	230	50	0.18	17	2100	222	18	37
FLA401055V2-M	230	50	0.22	17	2100	255	18	38

AC Cross Flow Fan

Ø40

- Dimension:

Unit: mm

Model	Air Outlet Length (C)	Pitch Row (B)	Total Length (A)	Curve
	mm	mm	mm	
FLA40530V2-M	530	540	600	Ⓐ
FLA40610V2-M	610	620	680	Ⓑ
FLA40700V2-M	700	710	770	Ⓒ
FLA40800V2-M	800	810	870	Ⓓ
FLA40854V2-M	854	864	924	Ⓔ
FLA40920V2-M	920	930	990	Ⓕ
FLA401055V2-M	1055	1065	1125	Ⓖ

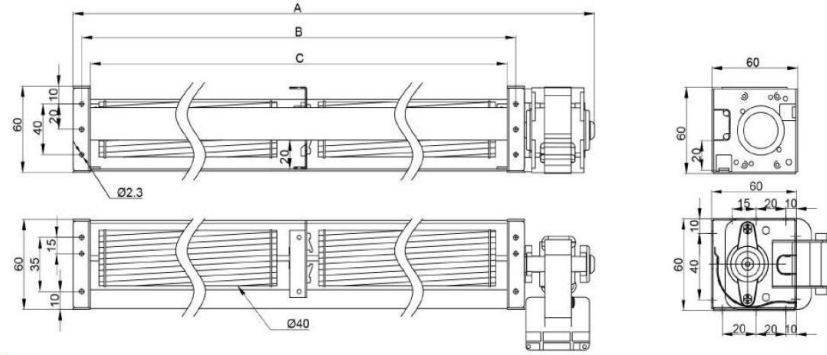

Unit: mm

AC Cross Flow Fan

Ø40

- Performance:

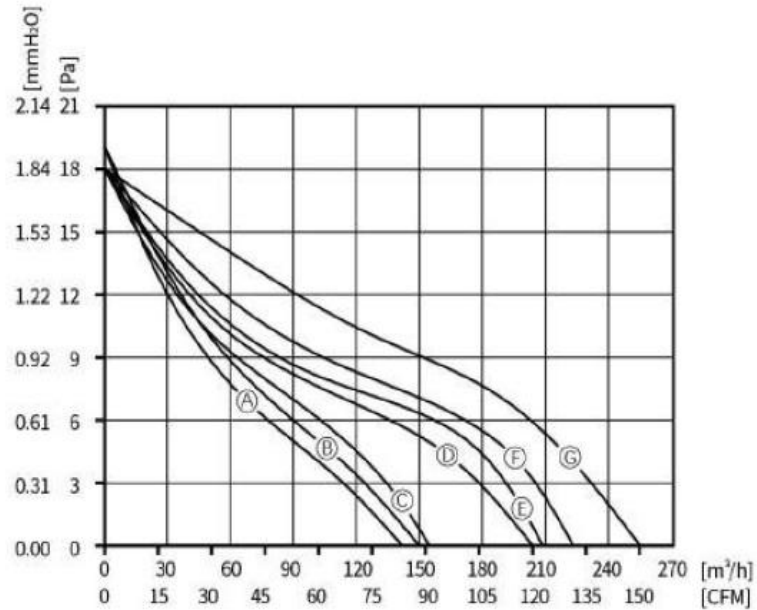

AC Cross Fan

Ø40 - B Type

- Housing: Metal
- Impeller: Aluminum
- Protection: Impedance Protection
- Certification: CE, RoHS
- Additional functions are optional



Model	Voltage	Frequency	Current	Power	Speed	Air Flow	Pressure	Noise
	VAC	Hz	Amp	Watt	RPM	m3/h	Pa	dB(A)
FLA4098V1-M2	115	60	0.23	16.2	3200	40	25	35
FLA4098V2-M2	230	50	0.1	13.9	2700	36	20	35
FLA40160V1-M2	115	60	0.24	16.8	3000	62	24	36
FLA40160V2-M2	230	50	0.11	14.6	2500	57	19	36
FLA40198V1-M2	115	60	0.25	17.2	2900	77	24	36
FLA40198V2-M2	230	50	0.11	14.5	2400	68	19	36
FLA40250V1-M2	115	60	0.32	21.9	3000	98	24	38
FLA40250V2-M2	230	50	0.13	18.5	2500	90	19	37

AC Cross Fan

Ø40 - B Type

- Housing: Metal
- Impeller: Aluminum
- Protection: Impedance Protection
- Certification: CE, RoHS
- Additional functions are optional



Model	Voltage	Frequency	Current	Power	Speed	Air Flow	Pressure	Noise
	VAC	Hz	Amp	Watt	RPM	m3/h	Pa	dB(A)
FLA40300V1-M2	115	60	0.33	22.6	2800	113	23	39
FLA40300V2-M2	230	50	0.13	18.7	2400	106	19	38
FLA40348V1-M2	115	60	0.3	20.5	2900	152	24	39
FLA40348V2-M2	230	50	0.14	19.6	2500	132	19	37
FLA40420V1-M2	115	60	0.31	21.6	2700	170	22	38
FLA40420V2-M2	230	50	0.14	20	2500	163	19	37

AC Cross Flow Fan

Ø40 - B Type

- Dimension:

Unit: mm

Model	Air Outlet Length (C)	Pitch Row (B)	Total Length (A)	Curve
	mm	mm	mm	
FLA4098V1-M2	98	108	158	Ⓐ
FLA4098V2-M2	98	108	158	Ⓐ
FLA40160V1-M2	160	170	220	Ⓑ
FLA40160V2-M2	160	170	220	Ⓑ
FLA40198V1-M2	198	208	258	Ⓒ
FLA40198V2-M2	198	208	258	Ⓒ
FLA40250V1-M2	250	260	315	Ⓓ
FLA40250V2-M2	250	260	315	Ⓓ
FLA40300V1-M2	300	310	365	Ⓔ
FLA40300V2-M2	300	310	365	Ⓔ
FLA40348V1-M2	348	358	418	Ⓕ
FLA40348V2-M2	348	358	418	Ⓕ
FLA40420V1-M2	420	430	490	Ⓖ
FLA40420V2-M2	420	430	490	Ⓖ

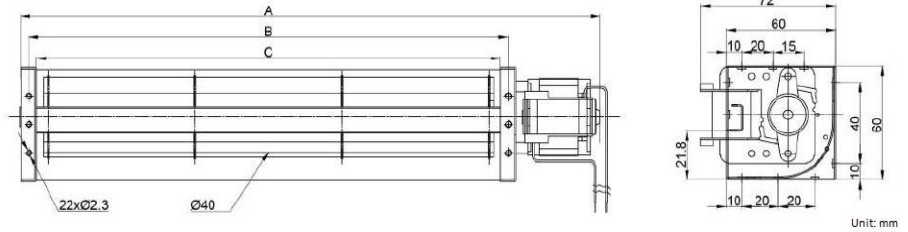

AC Cross Flow Fan

Ø40 - B Type

- Performance:

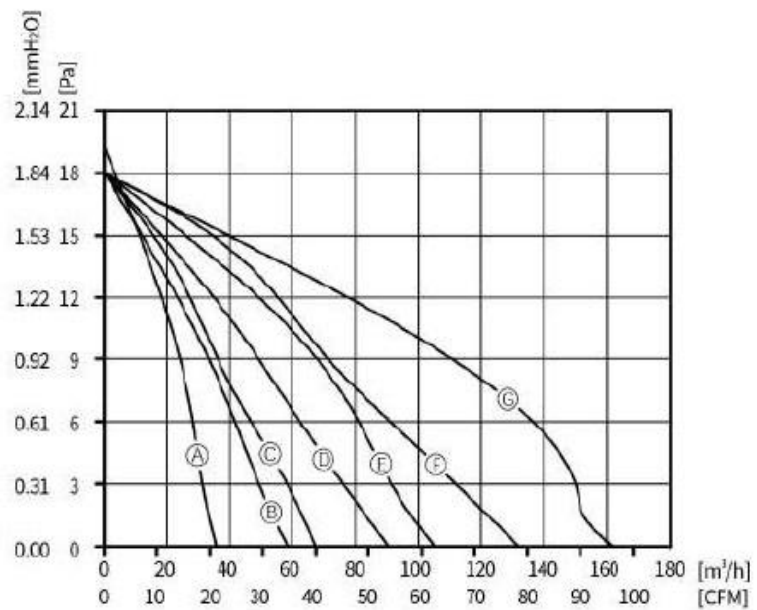

AC Cross Fan

Ø43

- Housing: Metal
- Impeller: Aluminum
- Protection: Impedance Protection
- Certification: CE, RoHS
- Additional functions are optional



Model	Voltage	Frequency	Current	Power	Speed	Air Flow	Pressure	Noise
	VAC	Hz	Amp	Watt	RPM	m3/h	Pa	dB(A)
FLA4398V1-M	115	60	0.25	16	3100	48	22	37
FLA4398V2-M	230	50	0.12	14	2600	41	18	37
FLA43160V1-M	115	60	0.26	17	2900	72	22	38
FLA43160V2-M	230	50	0.12	15	2400	61	16	38
FLA43198V1-M	115	60	0.26	17	2800	86	22	39
FLA43198V2-M	230	50	0.12	15	2300	70	14	38
FLA43250V1-M	115	60	0.37	22	2400	110	21	39
FLA43250V2-M	230	50	0.15	19	2400	90	15	38

AC Cross Fan

Ø43

- Housing: Metal
- Impeller: Aluminum
- Protection: Impedance Protection
- Certification: CE, RoHS
- Additional functions are optional



Model	Voltage	Frequency	Current	Power	Speed	Air Flow	Pressure	Noise
	VAC	Hz	Amp	Watt	RPM	m3/h	Pa	dB(A)
FLA43300V1-M	115	60	0.38	23	2700	135	21	40
FLA43300V2-M	230	50	0.16	19	2300	115	11	37
FLA43348V1-M	115	60	0.34	21	2700	150	19	41
FLA43348V2-M	230	50	0.18	21	2400	130	15	39
FLA43420V1-M	115	60	0.35	22	2700	170	20	42
FLA43420V2-M	230	50	0.18	20	2300	145	11	40

AC Cross Flow Fan

Ø43

- Dimension:

Unit: mm

Model	Air Outlet Length (C)	Pitch Row (B)	Total Length (A)	Curve
	mm	mm	mm	
FLA4398V1-M	98	108	158	Ⓐ
FLA4398V2-M	98	108	158	Ⓐ
FLA43160V1-M	160	170	218	Ⓑ
FLA43160V2-M	160	170	218	Ⓑ
FLA43198V1-M	198	208	265	Ⓒ
FLA43198V2-M	198	208	265	Ⓒ
FLA43250V1-M	250	260	316	Ⓓ
FLA43250V2-M	250	260	316	Ⓓ
FLA43300V1-M	300	310	370	Ⓔ
FLA43300V2-M	300	310	370	Ⓔ
FLA43348V1-M	340	358	417	Ⓕ
FLA43348V2-M	348	358	417	Ⓕ
FLA43420V1-M	420	430	491	Ⓖ
FLA43420V2-M	420	430	491	Ⓖ

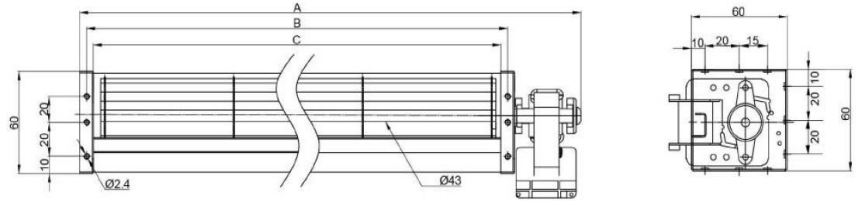

AC Cross Flow Fan

Ø43

- Performance:

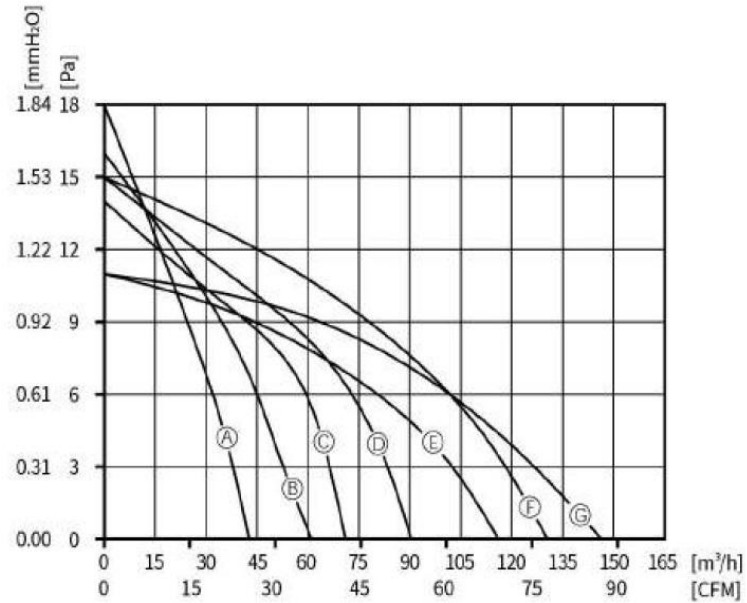

AC Cross Fan

Ø45

- Housing: Metal
- Impeller: Aluminum
- Protection: Impedance Protection
- Certification: CE, RoHS
- Additional functions are optional



Model	Voltage	Frequency	Current	Power	Speed	Air Flow	Pressure	Noise
	VAC	Hz	Amp	Watt	RPM	m3/h	Pa	dB(A)
FLA45530V2-M	230	50	0.28	39	2100	374	26	51
FLA45630V2-M	230	50	0.29	40	2000	384	28	50
FLA45700V2-M	230	50	0.29	41	1700	355	24	47
FLA45750V2-M	230	50	0.4	55	2000	495	28	51
FLA45820V2-M	230	50	0.4	55	1800	480	27	50
FLA45870V2-M	230	50	0.4	56	1700	505	27	49

AC Cross Flow Fan

Ø45

- Dimension:

Unit: mm

Model	Air Outlet Length (C)	Pitch Row (B)	Total Length (A)	Curve
	mm	mm	mm	
FLA45530V2-M	530	540	602	Ⓐ
FLA45630V2-M	630	640	702	Ⓑ
FLA45700V2-M	700	710	777	Ⓒ
FLA45750V2-M	750	760	842	Ⓓ
FLA45820V2-M	820	830	912	Ⓔ
FLA45870V2-M	870	880	962	Ⓕ

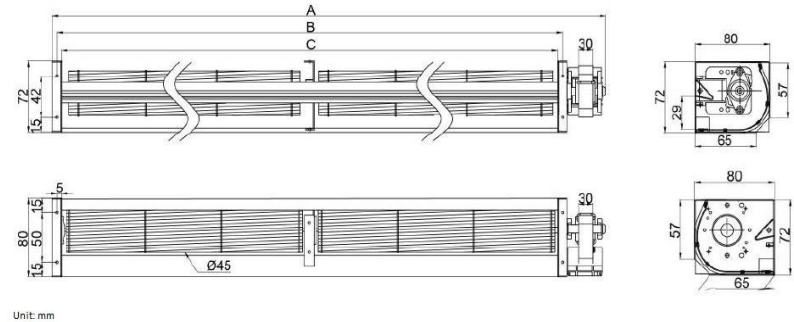

AC Cross Flow Fan

Ø45

- Performance:

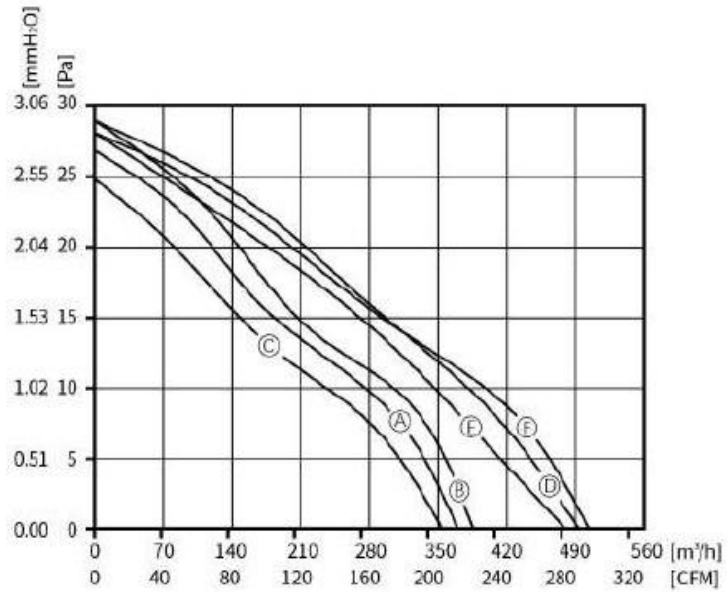

AC Cross Fan

Ø48

- Housing: Metal
- Impeller: Aluminum
- Protection: Impedance Protection
- Certification: CE, RoHS
- Additional functions are optional



Model	Voltage	Frequency	Current	Power	Speed	Air Flow	Pressure	Noise
	VAC	Hz	Amp	Watt	RPM	m3/h	Pa	dB(A)
FLA48572V2-M	230	50	0.31	43	2300	370	34	42
FLA48694V2-M	230	50	0.33	46	2100	350	33	40
FLA48784V2-M	230	50	0.34	47	1500	280	28	38
FLA48750V2-M	230	50	0.34	47	1350	270	25	36

AC Cross Flow Fan

Ø48

- Dimension:

Unit: mm

Model	Air Outlet Length (C)	Pitch Row (B)	Total Length (A)	Curve
	mm	mm	mm	
FLA48572V2-M	572	208	584	Ⓐ
FLA48694V2-M	694	269	706	Ⓑ
FLA48784V2-M	784	314	796	Ⓒ
FLA48750V2-M	750	384	936	Ⓓ

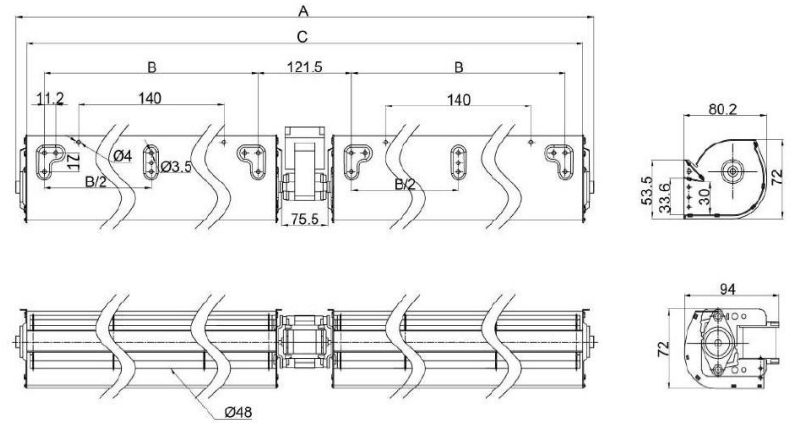

Unit: mm

AC Cross Flow Fan

Ø48

- Performance:

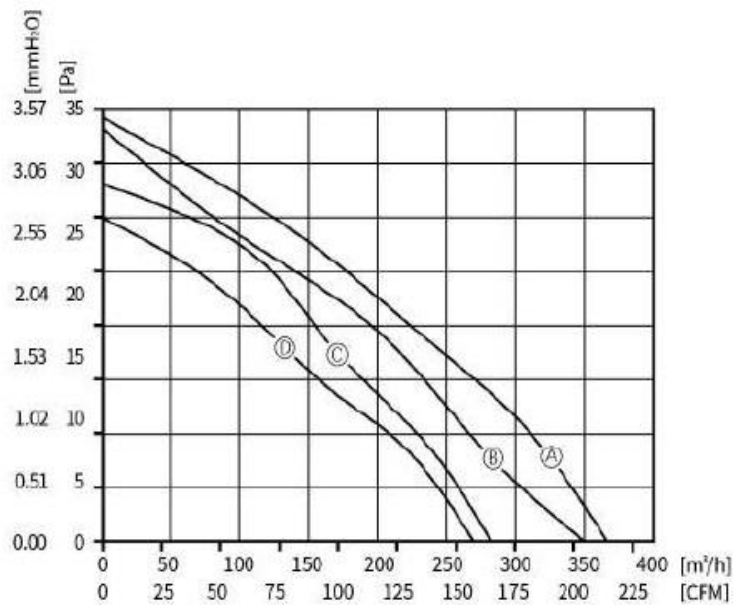

AC Cross Fan

Ø48 - B Type

- Housing: Metal
- Impeller: Aluminum
- Protection: Impedance Protection
- Certification: CE, RoHS
- Additional functions are optional



Model	Voltage	Frequency	Current	Power	Speed	Air Flow	Pressure	Noise
	VAC	Hz	Amp	Watt	RPM	m3/h	Pa	dB(A)
FLA4899V2-M2	230	50	0.06	7.5	1800	64	30	36
FLA48150V2-M2	230	50	0.18	11	1600	81	28	33
FLA48189V2-M2	230	50	0.16	18	1500	105	26	32
FLA48240V2-M2	230	50	0.25	29	2400	168	40	46
FLA48252V2-M2	230	50	0.26	29	2400	213	40	46
FLA48303V2-M2	230	50	0.28	30	2000	264	35	40
FLA48348V2-M2	230	50	0.29	35	2200	307	38	43
FLA48418V2-M2	230	50	0.32	35	2000	343	35	44

AC Cross Flow Fan

Ø48 - B Type

- Dimension:

Unit: mm

Model	Air Outlet Length (C)	Pitch Row (B)	Total Length (A)	Curve
	mm	mm	mm	
FLA4899V2-M2	99	66	150	Ⓐ
FLA48150V2-M2	150	114	200	Ⓑ
FLA48189V2-M2	189	154	246	Ⓒ
FLA48240V2-M2	240	206	298	Ⓓ
FLA48252V2-M2	252	216	310	Ⓔ
FLA48303V2-M2	303	269	361	Ⓕ
FLA48348V2-M2	348	314	413	Ⓖ
FLA48418V2-M2	418	384	493	Ⓖ

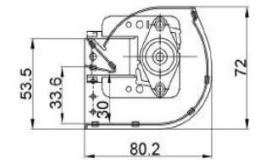
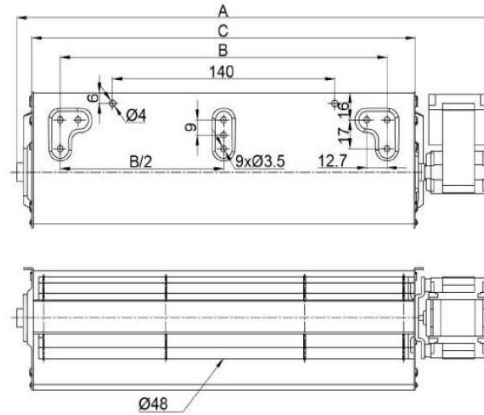

Unit: mm

AC Cross Flow Fan

Ø48 - B Type

- Performance:

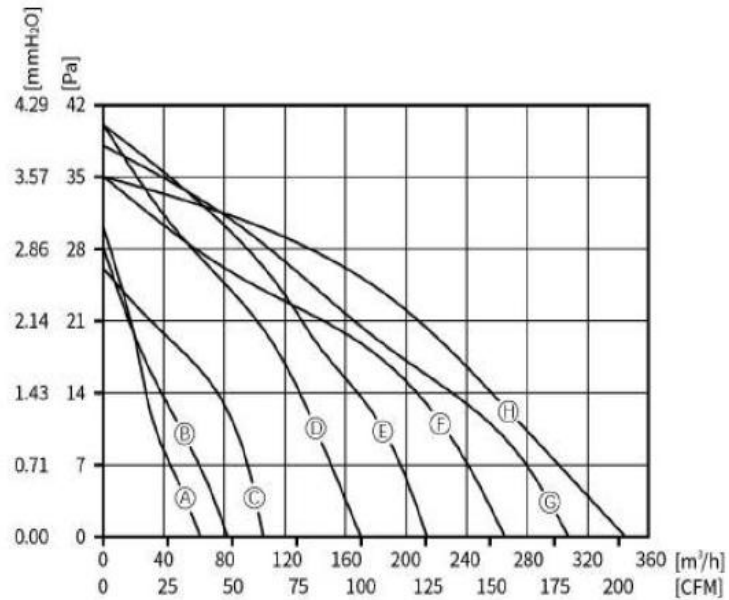

AC Cross Fan

Ø50

- Housing: Metal
- Impeller: Aluminum
- Protection: Impedance Protection
- Certification: CE, RoHS
- Additional functions are optional



Model	Voltage	Frequency	Current	Power	Speed	Air Flow	Pressure	Noise
	VAC	Hz	Amp	Watt	RPM	m3/h	Pa	dB(A)
FLA50612V2-M	230	50	0.29	36	2400	300	36	42
FLA50712V2-M	230	50	0.32	40	2100	335	32	41
FLA50832V2-M	230	50	0.35	41	1800	340	30	38
FLA50952V2-M	230	50	0.35	42	1300	260	28	36

AC Cross Flow Fan Ø50

- Dimension:

Unit: mm

Model	Air Outlet Length (C)	Pitch Row (B)	Total Length (A)	Curve
	mm	mm	mm	
FLA50612V2-M	612	258	632	Ⓐ
FLA50712V2-M	712	308	732	Ⓑ
FLA50832V2-M	832	368	852	Ⓒ
FLA50952V2-M	952	428	972	Ⓓ

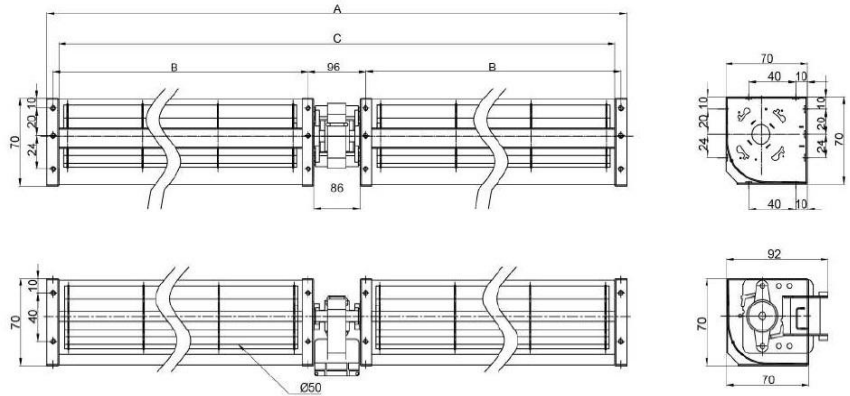

Unit: mm

AC Cross Flow Fan

Ø50

- Performance:

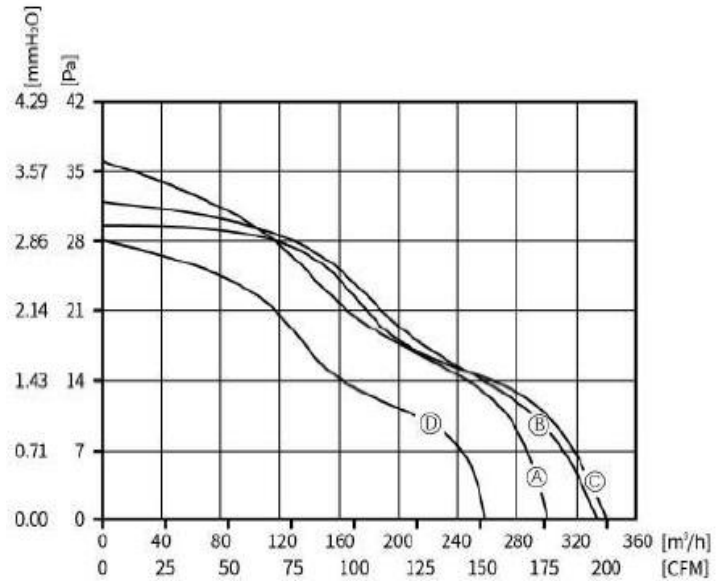

AC Cross Fan

Ø50 - B Type

- Housing: Metal
- Impeller: Aluminum
- Protection: Impedance Protection
- Certification: CE, RoHS
- Additional functions are optional



Model	Voltage	Frequency	Current	Power	Speed	Air Flow	Pressure	Noise
	VAC	Hz	Amp	Watt	RPM	m3/h	Pa	dB(A)
FLA5098V1-M2	115	60	0.45	27.2	3300	70	44	40
FLA5098V2-M2	230	50	0.23	25.2	2800	56	37	40
FLA50158V1-M2	115	60	0.47	30.1	3100	131	41	40
FLA50158V2-M2	230	50	0.24	25.9	2700	115	37	40
FLA50198V1-M2	115	60	0.48	32.1	2900	174	40	42
FLA50198V2-M2	230	50	0.24	28.2	2600	158	38	42
FLA50248V1-M2	115	60	0.5	33.5	3000	205	42	44
FLA50248V2-M2	230	50	0.25	30.6	2600	128	39	42

AC Cross Fan

Ø50 - B Type

- Housing: Metal
- Impeller: Aluminum
- Protection: Impedance Protection
- Certification: CE, RoHS
- Additional functions are optional



Model	Voltage	Frequency	Current	Power	Speed	Air Flow	Pressure	Noise
	VAC	Hz	Amp	Watt	RPM	m3/h	Pa	dB(A)
FLA50298V1-M2	115	60	0.52	34.5	2900	234	45	45
FLA50298V2-M2	230	50	0.26	31.2	2600	208	40	43
FLA50358V1-M2	115	60	0.92	58	3100	292	49	46
FLA50358V2-M2	230	50	0.46	51	2700	271	44	44
FLA50418V1-M2	115	60	0.96	62.4	3000	337	45	46
FLA50418V2-M2	230	50	0.47	52.4	2600	308	49	44

AC Cross Flow Fan

Ø50 - B Type

- Dimension:

Unit: mm

Model	Air Outlet Length (C)	Pitch Row (B)	Total Length (A)	Curve
	mm	mm	mm	
FLA5098V1-M2	98	108	170	Ⓐ
FLA5098V2-M2	98	108	170	Ⓐ
FLA50158V1-M2	158	168	231	Ⓑ
FLA50158V2-M2	158	168	231	Ⓑ
FLA50198V1-M2	198	208	271	Ⓒ
FLA50198V2-M2	198	208	271	Ⓒ
FLA50248V1-M2	248	258	326	Ⓓ
FLA50248V2-M2	248	258	326	Ⓓ
FLA50298V1-M2	298	308	376	Ⓔ
FLA50298V2-M2	298	308	376	Ⓔ
FLA50358V1-M2	358	368	436	Ⓕ
FLA50358V2-M2	358	368	436	Ⓕ
FLA50418V1-M2	418	428	496	Ⓖ
FLA50418V2-M2	418	428	496	Ⓖ

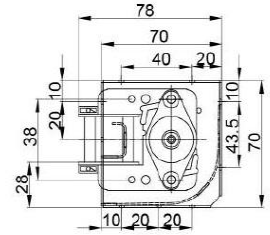
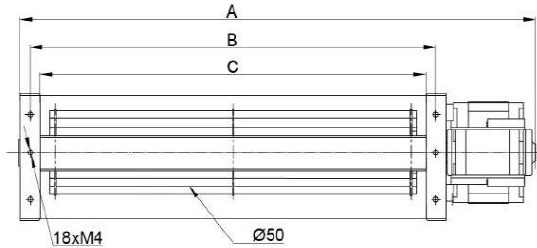

Unit: mm

AC Cross Flow Fan

Ø50 - B Type

- Performance:

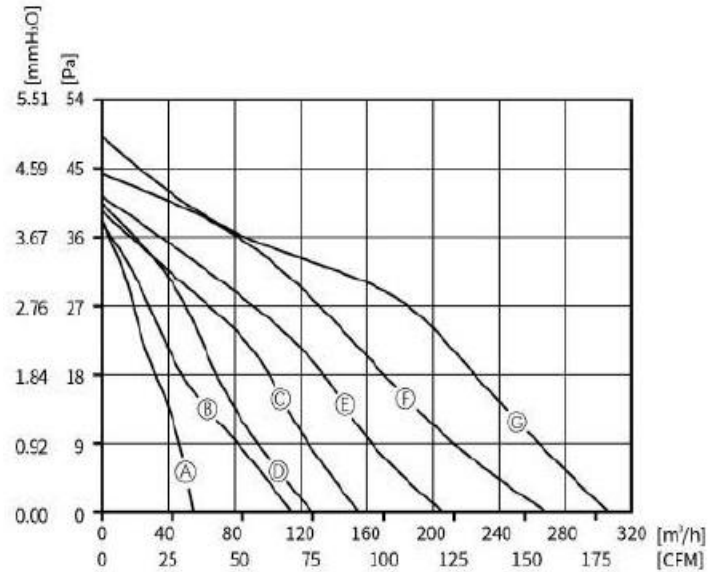

AC Cross Fan

Ø50 - C Type

- Housing: Metal
- Impeller: Aluminum
- Protection: Impedance Protection
- Certification: CE, RoHS
- Additional functions are optional



Model	Voltage	Frequency	Current	Power	Speed	Air Flow	Pressure	Noise
	VAC	Hz	Amp	Watt	RPM	m3/h	Pa	dB(A)
FLA50100V1-M3	115	60	0.37	20.7	3200	60	44	40
FLA50100V2-M3	230	50	0.15	17	2700	50	37	40
FLA50160V1-M3	115	60	0.38	21.6	3100	106	41	40
FLA50160V2-M3	230	50	0.15	17.3	2500	90	37	40
FLA50200V1-M3	115	60	0.38	23.3	3000	150	40	42
FLA50200V2-M3	230	50	0.16	17.6	2500	125	38	42
FLA50250V1-M3	115	60	0.38	19.7	3000	190	42	44
FLA50250V2-M3	230	50	0.18	19.8	2600	153	39	42

AC Cross Fan

Ø50 - C Type

- Housing: Metal
- Impeller: Aluminum
- Protection: Impedance Protection
- Certification: CE, RoHS
- Additional functions are optional



Model	Voltage	Frequency	Current	Power	Speed	Air Flow	Pressure	Noise
	VAC	Hz	Amp	Watt	RPM	m3/h	Pa	dB(A)
FLA50300V1-M3	115	60	0.32	20	2800	199	45	45
FLA50300V2-M3	230	50	0.18	19.6	2500	187	40	43
FLA50360V1-M3	115	60	0.33	20.9	2700	225	49	48
FLA50360V2-M3	230	50	0.18	20	2500	216	44	48
FLA50420V1-M3	115	60	0.35	21.1	2500	252	54	52
FLA50420V2-M3	230	50	0.19	21.1	2300	206	49	49

AC Cross Flow Fan

Ø50 - C Type

- Dimension:

Unit: mm

Model	Air Outlet Length (C)	Pitch Row (B)	Total Length (A)	Curve
	mm	mm	mm	
FLA50100V1-M3	100	110	163	Ⓐ
FLA50100V2-M3	100	110	163	Ⓐ
FLA50160V1-M3	160	170	223	Ⓑ
FLA50160V2-M3	160	170	223	Ⓑ
FLA50200V1-M3	200	210	263	Ⓒ
FLA50200V2-M3	200	210	263	Ⓒ
FLA50250V1-M3	250	260	318	Ⓓ
FLA50250V2-M3	250	260	318	Ⓓ
FLA50300V1-M3	300	310	368	Ⓔ
FLA50300V2-M3	300	310	368	Ⓔ
FLA50360V1-M3	360	370	428	Ⓕ
FLA50360V2-M3	360	370	428	Ⓕ
FLA50420V1-M3	420	430	488	Ⓖ
FLA50420V2-M3	420	430	488	Ⓖ

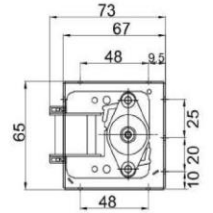
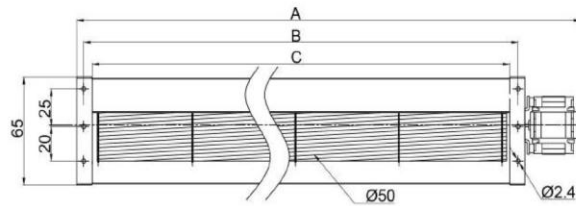

Unit: mm

AC Cross Flow Fan

Ø50 - C Type

- Performance:

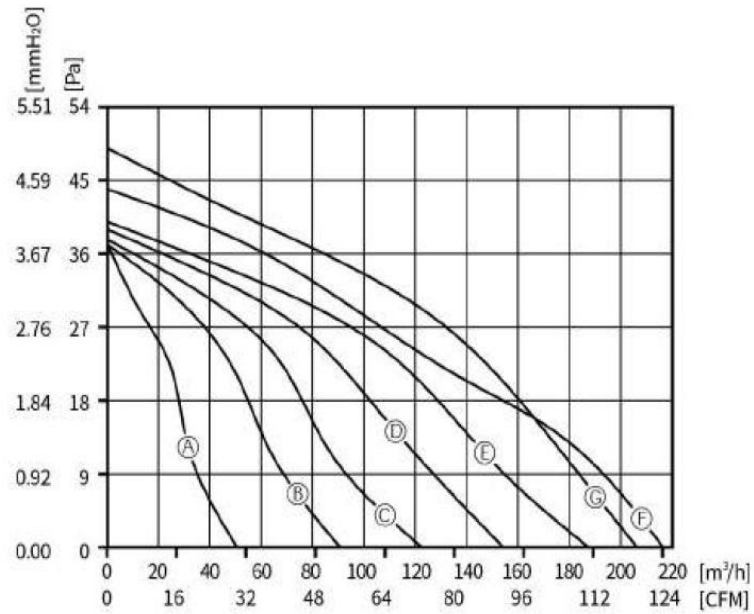

AC Cross Fan

Ø60

- Housing: Metal
- Impeller: Aluminum
- Protection: Impedance Protection
- Certification: CE, RoHS
- Additional functions are optional



Model	Voltage	Frequency	Current	Power	Speed	Air Flow	Pressure	Noise
	VAC	Hz	Amp	Watt	RPM	m3/h	Pa	dB(A)
FLA60184V2-M	230	50	0.24	28	2800	203	58	46
FLA60245V2-M	230	50	0.13	30	2700	239	58	45
FLA60306V2-M	230	50	0.15	33	2700	331	59	47
FLA60368V2-M	230	50	0.16	35	2600	337	49	49
FLA60429V2-M	230	50	0.17	37	2500	417	40	50

AC Cross Flow Fan

Ø60

- Dimension:

Unit: mm

Model	Air Outlet Length (C)	Pitch Row (B)	Total Length (A)	Curve
	mm	mm	mm	
FLA60184V2-M	184	199	285	Ⓐ
FLA60245V2-M	245	308	345	Ⓑ
FLA60306V2-M	306	321	405	Ⓒ
FLA60368V2-M	368	383	468	Ⓓ
FLA60429V2-M	429	444	530	Ⓔ

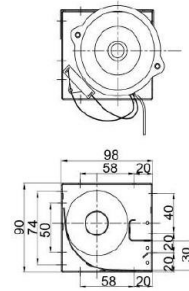
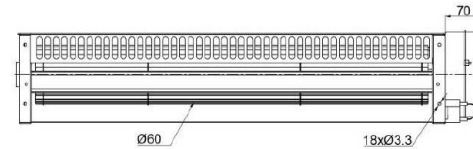
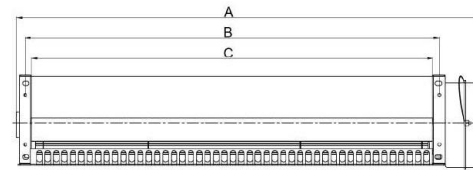

Unit: mm

AC Cross Flow Fan Ø60

- Performance:

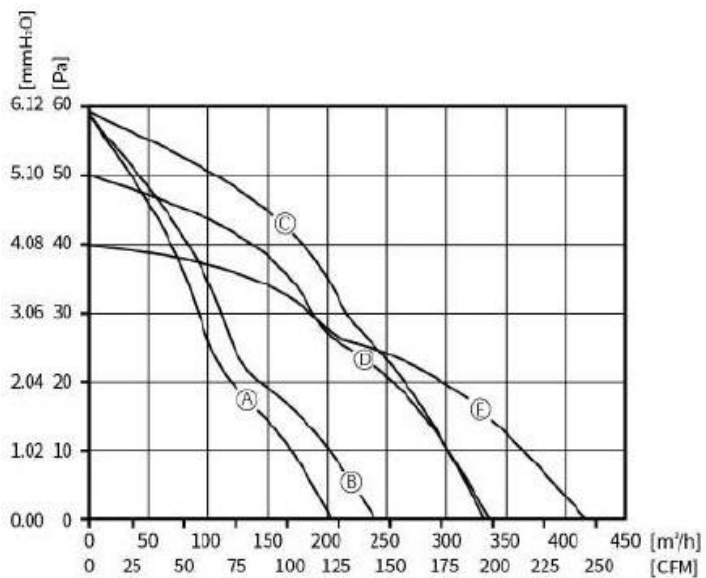

AC Cross Fan

Ø60 - B Type

- Housing: Metal
- Impeller: Aluminum
- Protection: Impedance Protection
- Certification: CE, RoHS
- Additional functions are optional



Model	Voltage	Frequency	Current	Power	Speed	Air Flow	Pressure	Noise
	VAC	Hz	Amp	Watt	RPM	m3/h	Pa	dB(A)
FLA60123V1-M2	115	60	0.47	30.9	3000	141	47	40
FLA60123V2-M2	230	50	0.24	28.5	2700	125	40	40
FLA60184V1-M2	115	60	0.54	34.4	2600	180	54	47
FLA60184V2-M2	230	50	0.25	32.1	2500	166	52	47
FLA60245V1-M2	115	60	0.57	35.8	2000	200	50	41
FLA60245V2-M2	230	50	0.27	34	2300	230	45	44

AC Cross Fan

Ø60 - B Type

- Housing: Metal
- Impeller: Aluminum
- Protection: Impedance Protection
- Certification: CE, RoHS
- Additional functions are optional



Model	Voltage	Frequency	Current	Power	Speed	Air Flow	Pressure	Noise
	VAC	Hz	Amp	Watt	RPM	m3/h	Pa	dB(A)
FLA60306V1-M2	115	60	0.99	62.5	2400	270	54	46
FLA60306V2-M2	230	50	0.47	53.1	2300	280	54	46
FLA60382V1-M2	115	60	1.01	64.1	1900	280	41	43
FLA60382V2-M2	230	50	0.49	56.9	1950	280	47	43
FLA60429V1-M2	115	60	1.01	64.5	1600	245	21	43
FLA60429V2-M2	230	50	0.41	39	1800	265	23	44

AC Cross Flow Fan

Ø60 - B Type

- Dimension:

Unit: mm

Model	Air Outlet Length (C)	Pitch Row (B)	Total Length (A)	Curve
	mm	mm	mm	
FLA60123V1-M2	123	138	190	Ⓐ
FLA60123V2-M2	123	138	190	Ⓐ
FLA60184V1-M2	184	199	251	Ⓑ
FLA60184V2-M2	184	199	251	Ⓑ
FLA60245V1-M2	245	260	312	Ⓒ
FLA60245V2-M2	245	260	312	Ⓒ
FLA60306V1-M2	306	321	378	Ⓓ
FLA60306V2-M2	306	321	378	Ⓓ
FLA60382V1-M2	368	382	440	Ⓔ
FLA60382V2-M2	368	382	440	Ⓔ
FLA60429V1-M2	429	444	501	Ⓕ
FLA60429V2-M2	429	444	501	Ⓕ

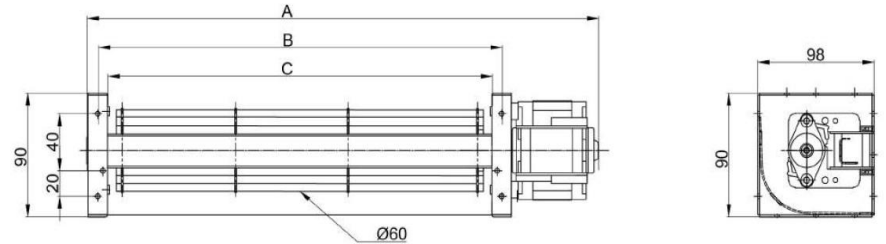

Unit: mm

AC Cross Flow Fan

Ø60 - B Type

- Performance:

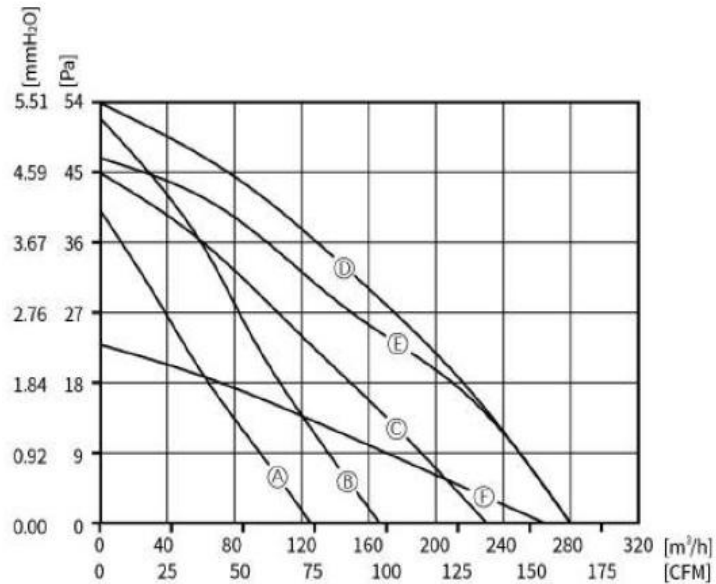

AC Cross Fan

Ø60 - C Type

- Housing: Metal
- Impeller: Aluminum
- Protection: Impedance Protection
- Certification: CE, RoHS
- Additional functions are optional



Model	Voltage	Frequency	Current	Power	Speed	Air Flow	Pressure	Noise
	VAC	Hz	Amp	Watt	RPM	m3/h	Pa	dB(A)
FLA60578V2-M3	230	50	0.36	40	1700	335	47	40
FLA60710V2-M3	230	50	0.36	40	1550	382	49	42
FLA60810V2-M3	230	50	0.36	41	1300	355	58	45
FLA60940V2-M3	230	50	0.37	41	1100	368	48	48

AC Cross Flow Fan

Ø60 - C Type

• Dimension:

Unit: mm

Model	Air Outlet Length (C)	Pitch Row (B)	Total Length (A)	Curve
	mm	mm	mm	
FLA60578V2-M3	578	254	588	Ⓐ
FLA60710V2-M3	710	315	720	Ⓑ
FLA60810V2-M3	810	365	820	Ⓒ
FLA60940V2-M3	940	430	950	Ⓓ

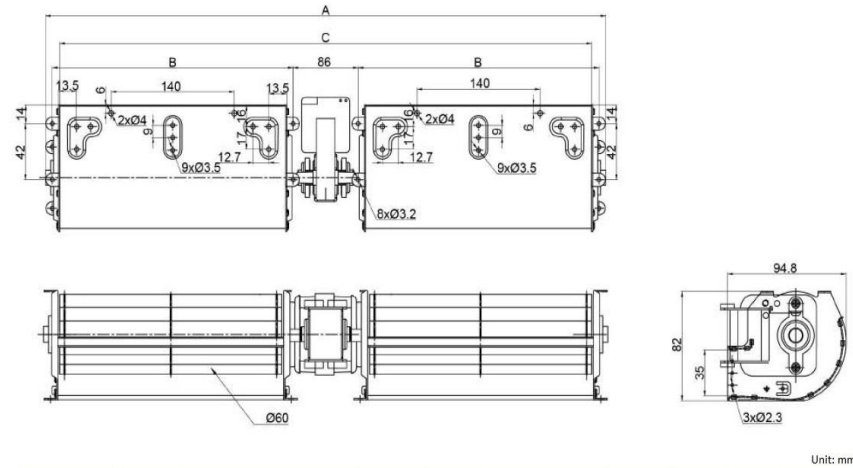

AC Cross Flow Fan

Ø60 - C Type

- Performance:

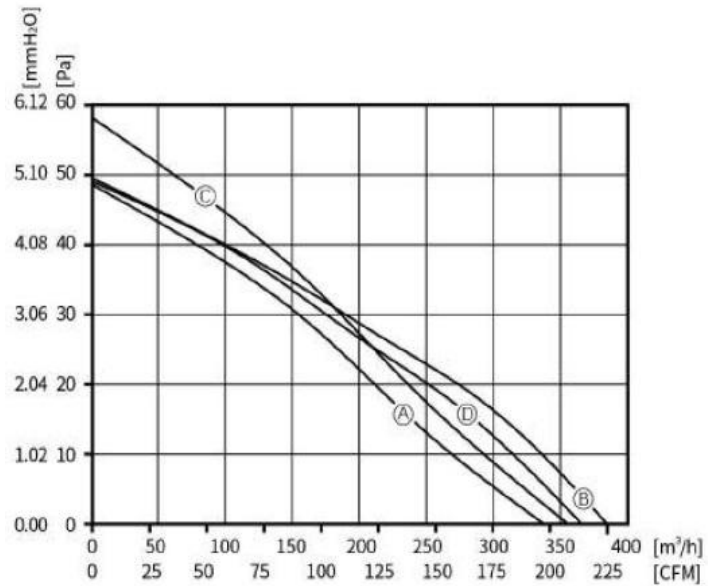

AC Cross Fan

Ø60 - D Type

- Housing: Metal
- Impeller: Aluminum
- Protection: Impedance Protection
- Certification: CE, RoHS
- Additional functions are optional



Model	Voltage	Frequency	Current	Power	Speed	Air Flow	Pressure	Noise
	VAC	Hz	Amp	Watt	RPM	m3/h	Pa	dB(A)
FLA60123V2-M4	230	50	0.15	24	2400	105	50	40
FLA60181V2-M4	230	50	0.34	36	2500	170	54	40
FLA60242V2-M4	230	50	0.34	40	2200	210	51	42
FLA60304V2-M4	230	50	0.32	41	2000	250	48	42
FLA60353V2-M4	230	50	0.34	45	1800	220	45	40
FLA60418V2-M4	230	50	0.34	46	1500	190	42	38

AC Cross Flow Fan

Ø60 - D Type

- Dimension:

Unit: mm

Model	Air Outlet Length (C)	Pitch Row (B)	Total Length (A)	Curve
	mm	mm	mm	
FLA60123V2-M4	123	134	191	Ⓐ
FLA60181V2-M4	181	193	259	Ⓑ
FLA60242V2-M4	242	265	335	Ⓒ
FLA60304V2-M4	304	315	397	Ⓓ
FLA60353V2-M4	353	365	446	Ⓔ
FLA60418V2-M4	418	430	511	Ⓕ

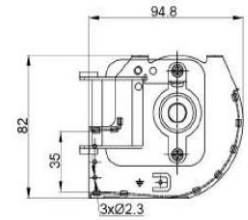
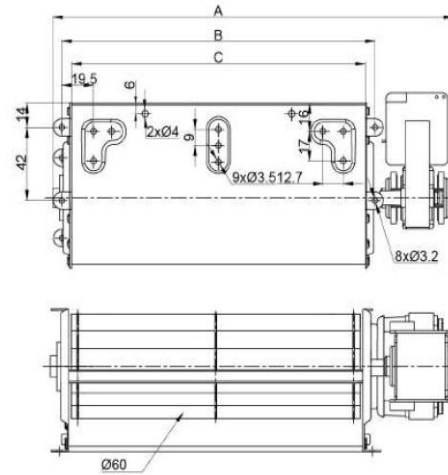

Unit: mm

AC Cross Flow Fan

Ø60 - D Type

- Performance:

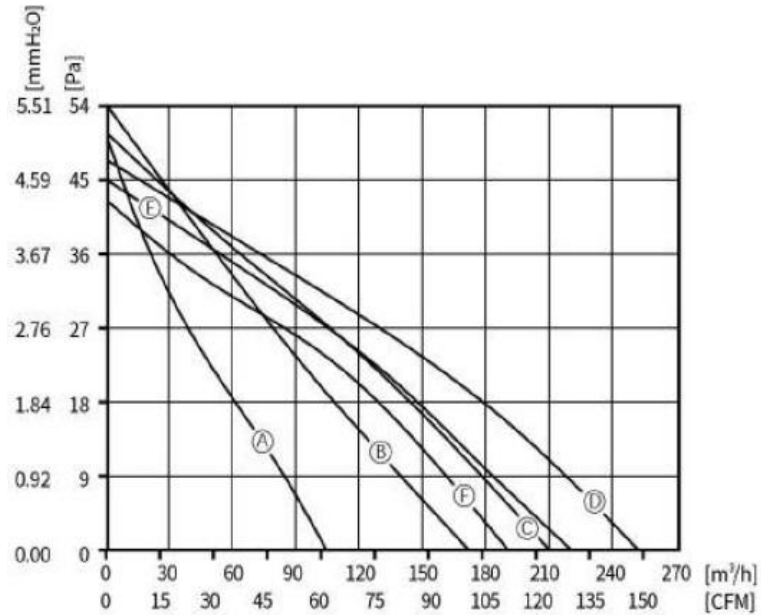

AC Cross Fan

Ø60 - E Type

- Housing: Metal
- Impeller: Aluminum
- Protection: Impedance Protection
- Certification: CE, RoHS
- Additional functions are optional



Model	Voltage	Frequency	Current	Power	Speed	Air Flow	Pressure	Noise
	VAC	Hz	Amp	Watt	RPM	m3/h	Pa	dB(A)
FLA60250V2-M5	230	50	0.17	24	2600	159	25	45
FLA60310V2-M5	230	50	0.18	25	2500	208	26	45
FLA60350V2-M5	230	50	0.19	26	2400	234	24	45
FLA60425V2-M5	230	50	0.2	27	2300	276	24	44
FLA60520V2-M5	230	50	0.22	31	2400	315	25	44
FLA60610V2-M5	230	50	0.23	32	2300	355	23	43

AC Cross Fan

Ø60 - E Type

- Housing: Metal
- Impeller: Aluminum
- Protection: Impedance Protection
- Certification: CE, RoHS
- Additional functions are optional



Model	Voltage	Frequency	Current	Power	Speed	Air Flow	Pressure	Noise
	VAC	Hz	Amp	Watt	RPM	m3/h	Pa	dB(A)
FLA60750V2-M5	230	50	0.25	34	2300	405	24	43
FLA60870V2-M5	230	50	0.25	35	2100	475	20	42
FLA60920V2-M5	230	50	0.33	46	2500	557	23	44
FLA601080V2-M5	230	50	0.36	50	2300	650	24	44
FLA601300V2-M5	230	50	0.38	52	2200	720	24	45

AC Cross Flow Fan

Ø60 - E Type

- Dimension:

Unit: mm

Model	Air Outlet Length (C)	Pitch Row (B)	Total Length (A)	Curve
	mm	mm	mm	
FLA60250V2-M5	250	268	321	Ⓐ
FLA60310V2-M5	310	328	381	Ⓑ
FLA60350V2-M5	350	368	421	Ⓒ
FLA60425V2-M5	425	443	496	Ⓓ
FLA60520V2-M5	520	538	596	Ⓔ
FLA60610V2-M5	610	628	686	Ⓕ
FLA60750V2-M5	750	768	831	Ⓖ
FLA60870V2-M5	870	888	951	Ⓗ
FLA60920V2-M5	920	938	1003	Ⓙ
FLA601080V2-M5	1080	1098	1163	Ⓚ
FLA601300V2-M5	1300	1318	1383	Ⓛ

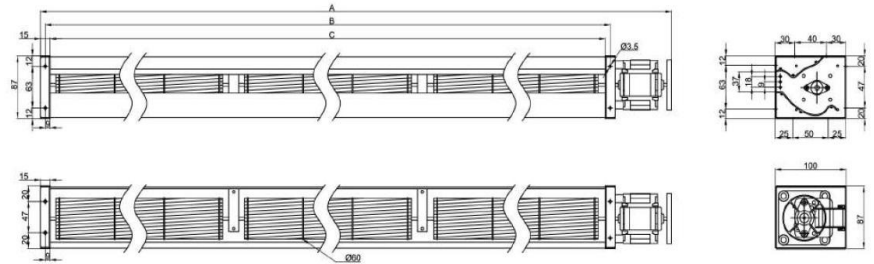

Unit: mm

AC Cross Flow Fan

Ø60 - E Type

- Performance:

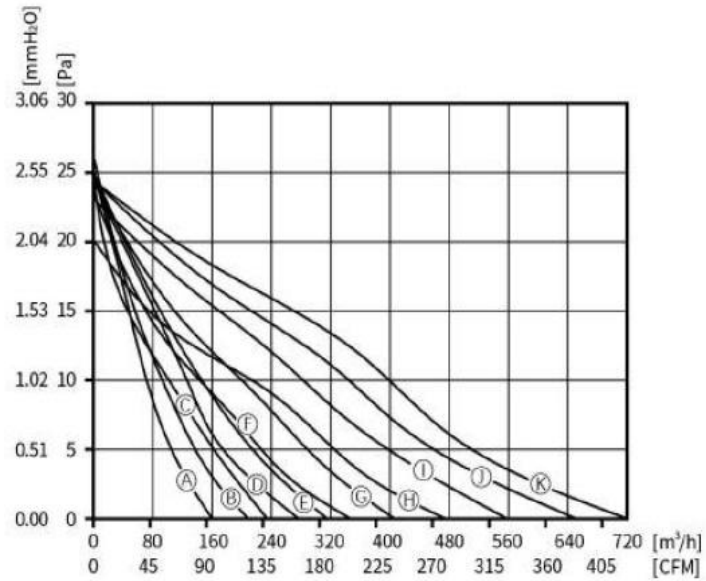

AC Cross Fan

Ø60 - F Type

- Housing: Metal
- Impeller: Aluminum
- Protection: Impedance Protection
- Certification: CE, RoHS
- Additional functions are optional



Model	Voltage	Frequency	Current	Power	Speed	Air Flow	Pressure	Noise
	VAC	Hz	Amp	Watt	RPM	m3/h	Pa	dB(A)
FLA60520V2-M6	230	50	0.15	24	1900	360	50	43
FLA60610V2-M6	230	50	0.34	35	1900	420	50	43
FLA60640V2-M6	230	50	0.19	40	1900	440	50	43
FLA60700V2-M6	230	50	0.19	41	1800	450	48	42
FLA60750V2-M6	230	50	0.2	45	1700	455	46	42
FLA60870V2-M6	230	50	0.21	50	1500	490	46	40

AC Cross Flow Fan

Ø60 - F Type

- Dimension:

Unit: mm

Model	Air Outlet Length (C)	Pitch Row (B)	Total Length (A)	Curve
	mm	mm	mm	
FLA60520V2-M6	520	535	600	Ⓐ
FLA60610V2-M6	610	625	690	Ⓑ
FLA60640V2-M6	640	655	720	Ⓒ
FLA60700V2-M6	700	715	780	Ⓓ
FLA60750V2-M6	750	765	830	Ⓔ
FLA60870V2-M6	870	885	950	Ⓕ

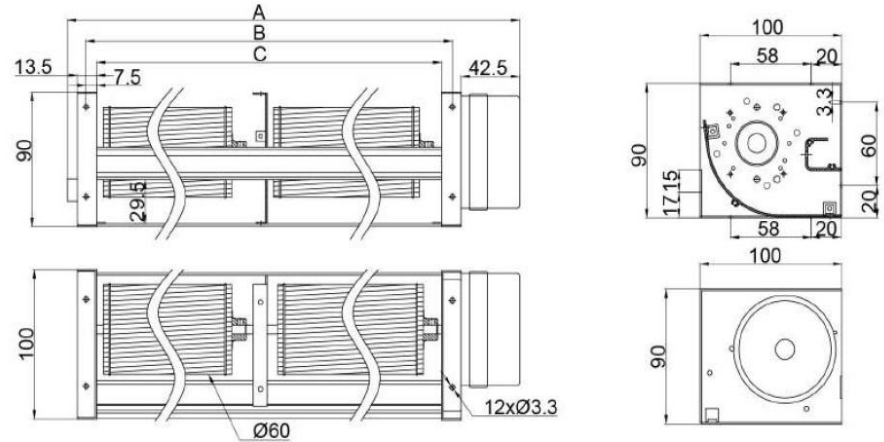

Unit: mm

AC Cross Flow Fan

Ø60 - F Type

- Performance:

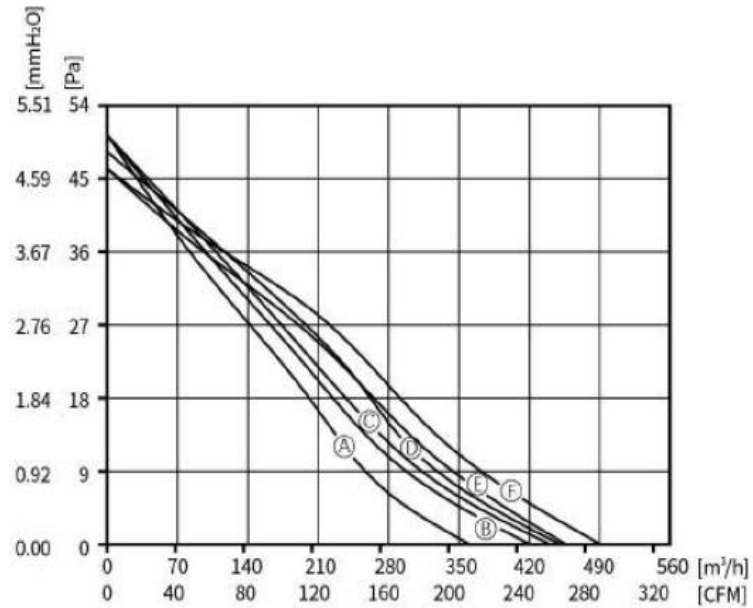

AC Cross Fan

Ø65

- Housing: Metal
- Impeller: Aluminum
- Protection: Impedance Protection
- Certification: CE, RoHS
- Additional functions are optional



Model	Voltage	Frequency	Current	Power	Speed	Air Flow	Pressure	Noise
	VAC	Hz	Amp	Watt	RPM	m3/h	Pa	dB(A)
FLA65592V2-M	230	50	0.36	42.6	1400	295	13	41
FLA65712V2-M	230	50	0.36	42.6	1300	310	12	42
FLA65832V2-M	230	50	0.36	42.7	1250	340	11	45
FLA65952V2-M	230	50	0.36	42.6	1100	350	11	45

AC Cross Flow Fan

Ø65

- Dimension:

Unit: mm

Model	Air Outlet Length (C)	Pitch Row (B)	Total Length (A)	Curve
	mm	mm	mm	
FLA65592V2-M	592	252	602	Ⓐ
FLA65712V2-M	712	312	722	Ⓑ
FLA65832V2-M	832	372	842	Ⓒ
FLA65952V2-M	952	432	962	Ⓓ

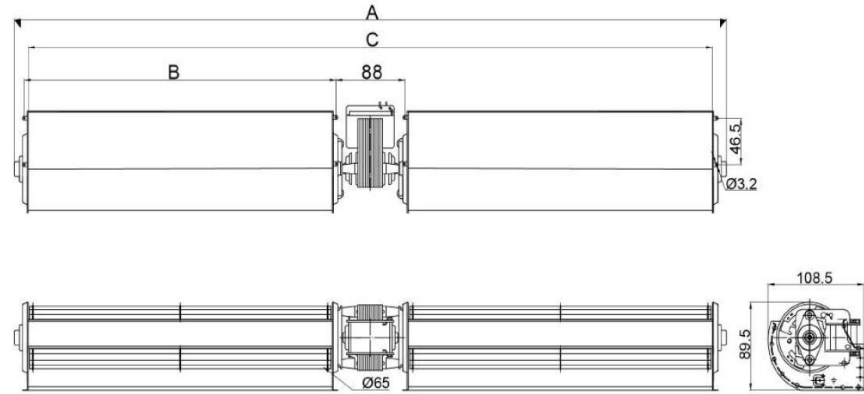

Unit: mm

AC Cross Flow Fan

Ø65

- Performance:

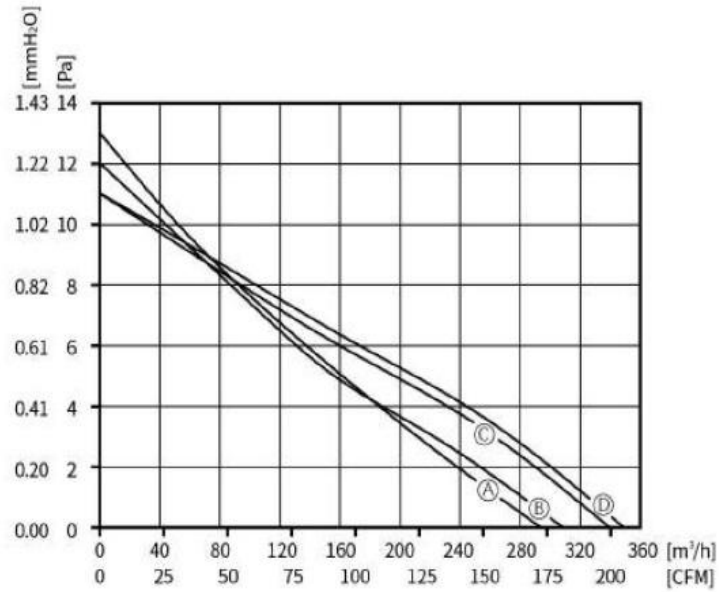

AC Cross Fan

Ø65 - B Type

- Housing: Metal
- Impeller: Aluminum
- Protection: Impedance Protection
- Certification: CE, RoHS
- Additional functions are optional



Model	Voltage	Frequency	Current	Power	Speed	Air Flow	Pressure	Noise
	VAC	Hz	Amp	Watt	RPM	m3/h	Pa	dB(A)
FLA65190V2-M2	230	50	0.25	35	1900	254	36	46
FLA65242V2-M2	230	50	0.28	38	1500	262	30	45
FLA65302V2-M2	230	50	0.3	42	1300	302	27	42
FLA65362V2-M2	230	50	0.33	45	1200	355	25	41

AC Cross Flow Fan

Ø65 - B Type

- Dimension:

Unit: mm

Model	Air Outlet Length (C)	Pitch Row (B)	Total Length (A)	Curve
	mm	mm	mm	
FLA65190V2-M2	190	200	256	Ⓐ
FLA65242V2-M2	242	252	313	Ⓑ
FLA65302V2-M2	302	312	385	Ⓒ
FLA65362V2-M2	362	372	447	Ⓓ

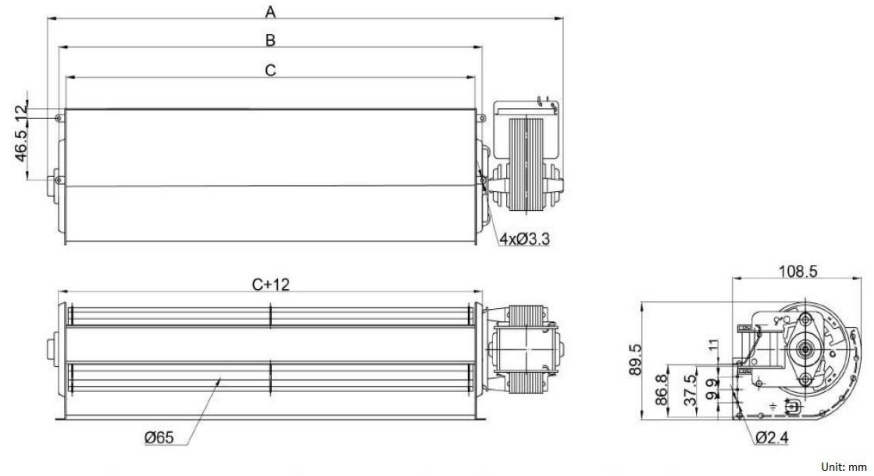

AC Cross Flow Fan

Ø65 - B Type

- Performance:

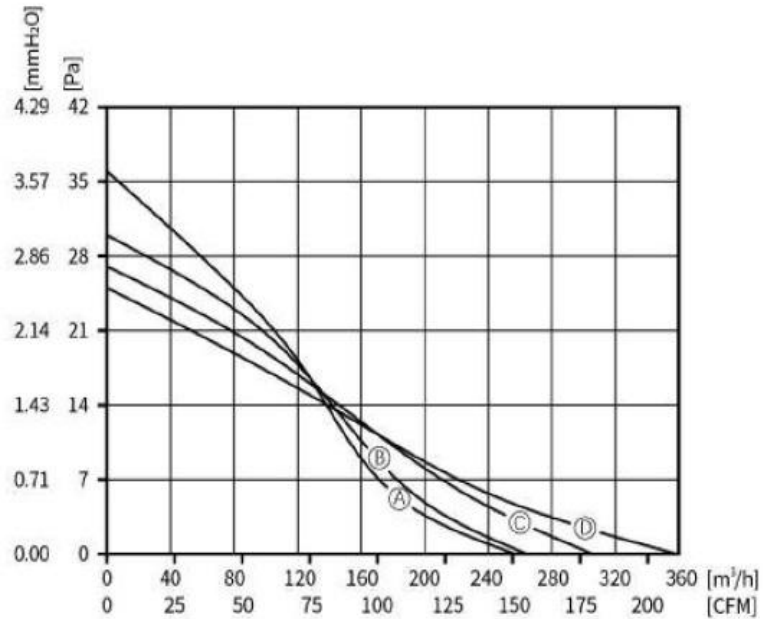

AC Cross Fan

Ø65 - C Type

- Housing: Metal
- Impeller: Aluminum
- Protection: Impedance Protection
- Certification: CE, RoHS
- Additional functions are optional



Model	Voltage	Frequency	Current	Power	Speed	Air Flow	Pressure	Noise
	VAC	Hz	Amp	Watt	RPM	m3/h	Pa	dB(A)
FLA65520V2-M3	230	50	0.2	40	1500	550	45	36
FLA65620V2-M3	230	50	0.2	42	1300	610	42	35

AC Cross Flow Fan

Ø65 - C Type

- Performance:

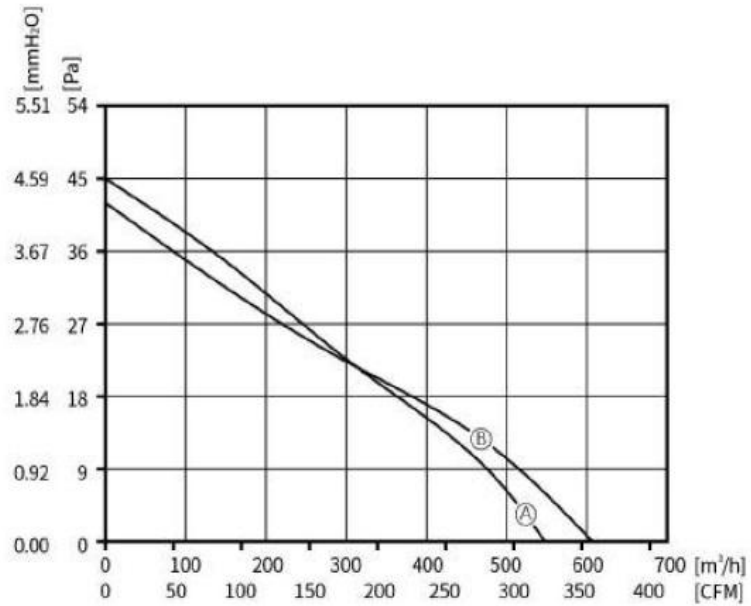

AC Cross Fan

Ø80

- Housing: Metal
- Impeller: Aluminum
- Protection: Impedance Protection
- Certification: CE, RoHS
- Additional functions are optional



Model	Voltage	Frequency	Current	Power	Speed	Air Flow	Pressure	Noise
	VAC	Hz	Amp	Watt	RPM	m3/h	Pa	dB(A)
FLA80250V2-M	230	50	0.3	65	2300	486	88	58
FLA80300V2-M	230	50	0.32	70	2100	562	78	58
FLA80360V2-M	230	50	0.34	74	1950	648	71	58
FLA80420V2-M	230	50	0.35	75	1900	696	69	55

AC Cross Flow Fan Ø80

- Dimension:

Unit: mm

Model	Air Outlet Length (C)	Pitch Row (B)	Total Length (A)	Curve
	mm	mm	mm	
FLA80250V2-M	250	200	359	Ⓐ
FLA80300V2-M	300	319	409	Ⓑ
FLA80360V2-M	360	379	469	Ⓒ
FLA80420V2-M	420	439	529	Ⓓ

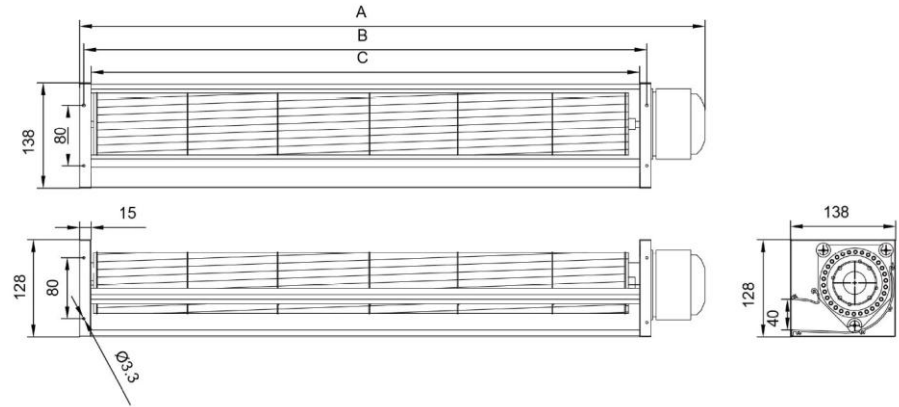

AC Cross Flow Fan

Ø80

- Performance:

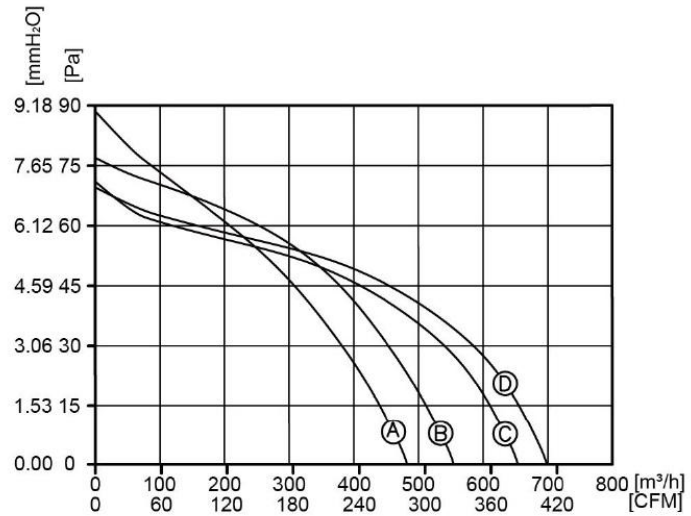

AC Cross Fan

Ø80 - B Type

- Housing: Metal
- Impeller: Aluminum
- Protection: Impedance Protection
- Certification: CE, RoHS
- Additional functions are optional



Model	Voltage	Frequency	Current	Power	Speed	Air Flow	Pressure	Noise
	VAC	Hz	Amp	Watt	RPM	m3/h	Pa	dB(A)
FLA80440V2-M2	230	50	0.35	76.5	1800	697	64	55
FLA80520V2-M2	230	50	0.25	46.7	1420	592	54	55
FLA80620V2-M2	230	50	0.25	47.5	1400	705	49	55
FLA80720V2-M2	230	50	0.26	49.3	1400	819	49	56
FLA80750V2-M2	230	50	0.26	50	1400	853	49	56

AC Cross Fan

Ø80 - B Type

- Housing: Metal
- Impeller: Aluminum
- Protection: Impedance Protection
- Certification: CE, RoHS
- Additional functions are optional



Model	Voltage	Frequency	Current	Power	Speed	Air Flow	Pressure	Noise
	VAC	Hz	Amp	Watt	RPM	m3/h	Pa	dB(A)
FLA80820V2-M2	230	50	0.27	52	1350	921	47	57
FLA80870V2-M2	230	50	0.27	52	1350	977	47	57
FLA801070V2-M2	230	50	0.3	61	1200	1171	41	57
FLA801270V2-M2	230	50	0.31	64	1200	1390	41	57

AC Cross Flow Fan

Ø80 - B Type

- Dimension:

Unit: mm

Model	Air Outlet Length (C)	Pitch Row (B)	Total Length (A)	Curve
	mm	mm	mm	
FLA80440V2-M2	440	459	549	Ⓐ
FLA80520V2-M2	520	539	629	Ⓑ
FLA80620V2-M2	620	639	729	Ⓒ
FLA80720V2-M2	720	739	829	Ⓓ
FLA80750V2-M2	720	769	859	Ⓔ
FLA80820V2-M2	820	839	929	Ⓕ
FLA80870V2-M2	870	889	979	Ⓖ
FLA801070V2-M2	1070	1089	1179	Ⓖ
FLA801270V2-M2	1270	1289	1379	Ⓖ

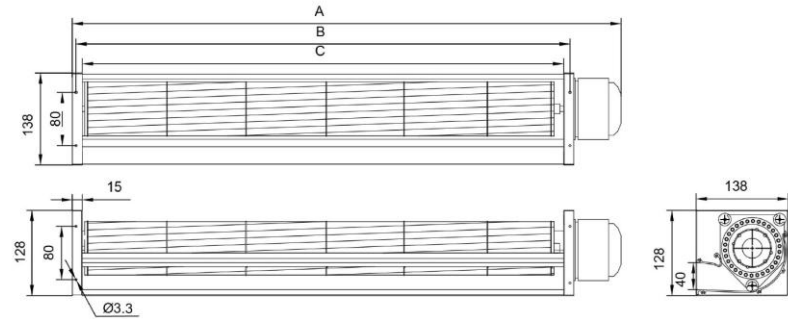

AC Cross Flow Fan

Ø80 - B Type

- Performance:

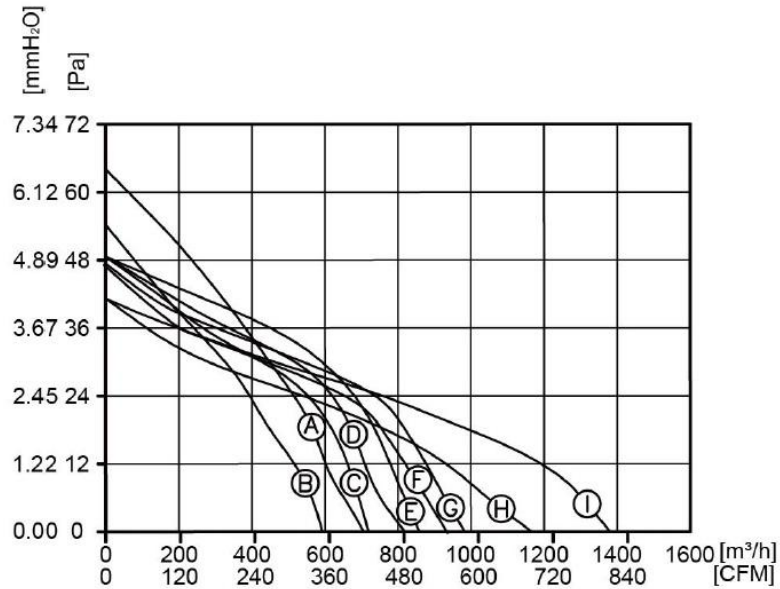

AC Cross Fan

Ø100

- Housing: Metal
- Impeller: Aluminum
- Protection: Impedance Protection
- Certification: CE, RoHS
- Additional functions are optional



Model	Voltage	Frequency	Current	Power	Speed	Air Flow	Pressure	Noise
	VAC	Hz	Amp	Watt	RPM	m3/h	Pa	dB(A)
FLA100195V2-M	230	50	0.15	22	1350	340	87	54
FLA100365V2-M	230	50	0.27	40	1250	640	86	57
FLA100515V2-M	230	50	0.33	50	1200	890	80	61
FLA100765V2-M	230	50	0.4	60	1050	1150	74	63

AC Cross Flow Fan

Ø100

- Dimension:

Unit: mm

Model	Air Outlet Length (C)	Pitch Row (B)	Total Length (A)	Curve
	mm	mm	mm	
FLA100195V2-M	195	210	280.5	Ⓐ
FLA100365V2-M	365	380	450.5	Ⓑ
FLA100515V2-M	515	530	600.5	Ⓒ
FLA100765V2-M	765	780	850.5	Ⓓ

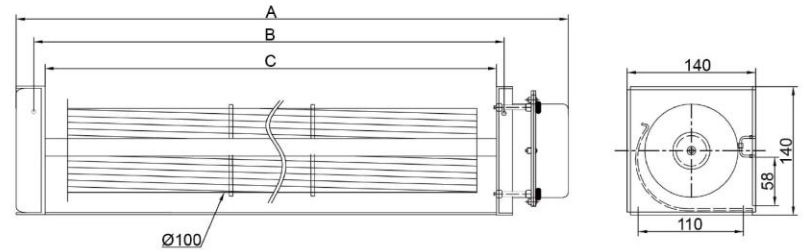

AC Cross Flow Fan

Ø100

- Performance:

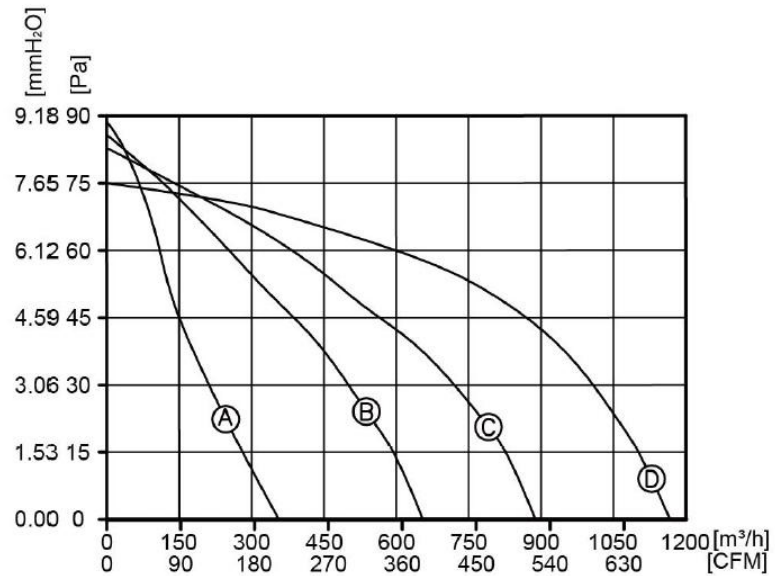

AC Cross Fan

Ø120

- Housing: Metal
- Impeller: Aluminum
- Protection: Impedance Protection
- Certification: CE, RoHS
- Additional functions are optional



Model	Voltage	Frequency	Current	Power	Speed	Air Flow	Pressure	Noise
	VAC	Hz	Amp	Watt	RPM	m3/h	Pa	dB(A)
FLA120195V2-M	230	50	0.27	40	1400	502	95	58
FLA120365V2-M	230	50	0.4	60	1330	968	95	62
FLA120515V2-M	230	50	0.4	60	960	1055	94	63
FLA120715V2-M	230	50	0.4	60	960	1449	92	65
FLA120915V2-M	230	50	0.4	60	900	1822	90	67

AC Cross Flow Fan Ø120

- Dimension:

Unit: mm

Model	Air Outlet Length (C)	Pitch Row (B)	Total Length (A)	Curve
	mm	mm	mm	
FLA120195V2-M	195	215	323	Ⓐ
FLA120365V2-M	365	385	493	Ⓑ
FLA120515V2-M	515	535	643	Ⓒ
FLA120715V2-M	715	735	843	Ⓓ
FLA120915V2-M	915	935	1043	Ⓔ

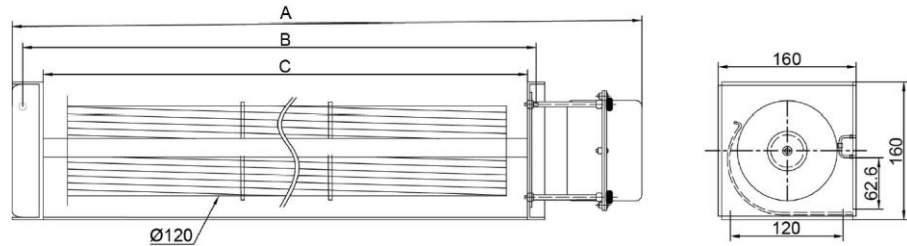

AC Cross Flow Fan

Ø120

- Performance:

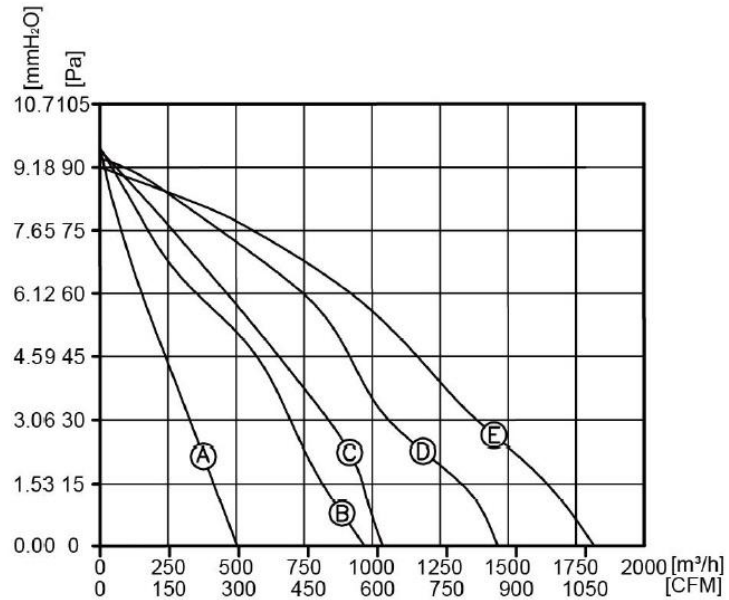

AC Cross Fan

Ø150

- Housing: Metal
- Impeller: Aluminum
- Protection: Impedance Protection
- Certification: CE, RoHS
- Additional functions are optional



Model	Voltage	Frequency	Current	Power	Speed	Air Flow	Pressure	Noise
	VAC	Hz	Amp	Watt	RPM	m3/h	Pa	dB(A)
FLA150270V2-M	230	50	0.6	90	1150	1050	110	62
FLA150368V2-M	230	50	0.8	120	1100	1430	105	63
FLA150518V2-M	230	50	1.07	160	1000	2000	100	65
FLA150718V2-M	230	50	1.47	220	1000	2800	93	68
FLA150918V2-M	230	50	1.87	280	900	3200	86	71
FLA1501215V2-M	230	50	2.21	330	860	4200	85	75

AC Cross Flow Fan

Ø150

- Dimension:

Unit: mm

Model	Air Outlet Length (C)	Pitch Row (B)	Total Length (A)	Curve
	mm	mm	mm	
FLA150270V2-M	270	298	398	Ⓐ
FLA150368V2-M	368	388	496	Ⓑ
FLA150518V2-M	518	538	646	Ⓒ
FLA150718V2-M	718	732	850	Ⓓ
FLA150918V2-M	918	938	1063	Ⓔ
FLA1501215V2-M	1215	1235	1435	Ⓕ

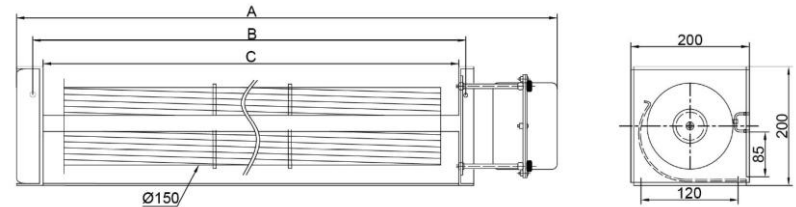

AC Cross Flow Fan

Ø150

- Performance:

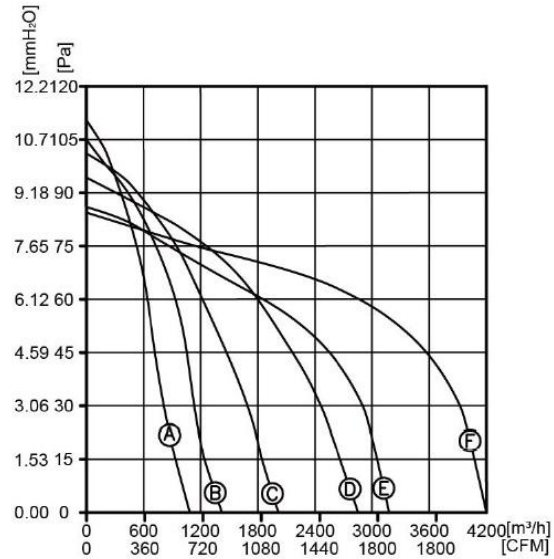



Change is a perpetual motion

Phone: +886-7-215-0001

Mobile: +886-938-016696

E-mail: service@cainton.com

Address: 9F.-1, No. 171,
Bizhong St., Yancheng Dist.,
Kaohsiung City 803002, Taiwan (R.O.C.)

www.cainton.com